

±10,000 SF R&D Sublease

46791 Fremont Boulevard, Fremont



±10,000 Square Feet Available

We are pleased to offer the following space:

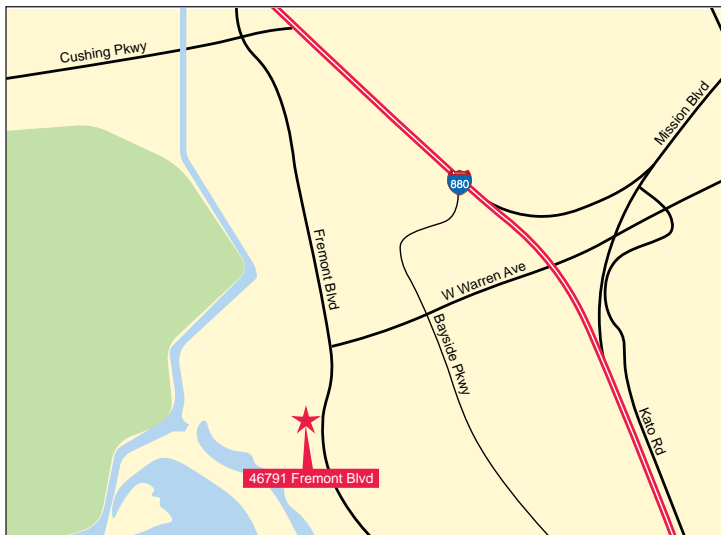

- ◆ Easy Access to I-880 and Highway 237
- ◆ Minutes to the Warm Springs Bart Station
- ◆ End Unit
- ◆ 60% Drop Ceiling
- ◆ Two (2) Dock High Doors
- ◆ Two (2) Grade Level Doors
- ◆ 16' Clear Height
- ◆ Sprinklered
- ◆ Walk and Bike on the Coyote Creek Lagoon Trail
- ◆ Available June 15, 2018
- ◆ LED: April 30, 2020

Derek Yep Director 408.987.4106 dyep@ngkf.com CA RE License #01476099

Clayton Jones Associate 650.473.4774 clayton.jones@ngkf.com CA RE License #02014728

Jon Cannon Executive Managing Director 650.688.8525 jcannon@ngkf.com CA RE License #01836599

**Newmark
Knight Frank**

2804 Mission College Boulevard., Suite 120, Santa Clara, CA 95054 www.ngkf.com

±10,000 SF R&D Sublease

46791 Fremont Boulevard, Fremont



* Furniture not included

Derek Yep Director 408.987.4106 dyep@ngkf.com CA RE License #01476099

Clayton Jones Associate 650.473.4774 clayton.jones@ngkf.com CA RE License #02014728

Jon Cannon Executive Managing Director 650.688.8525 jcannon@ngkf.com CA RE License #01836599

**Newmark
Knight Frank**

2804 Mission College Boulevard., Suite 120, Santa Clara, CA 95054 www.ngkf.com

±10,000 SF R&D Sublease

46791 Fremont Boulevard, Fremont



Premises Floor Plan*

* Most but Not All Equipment is Still in Place

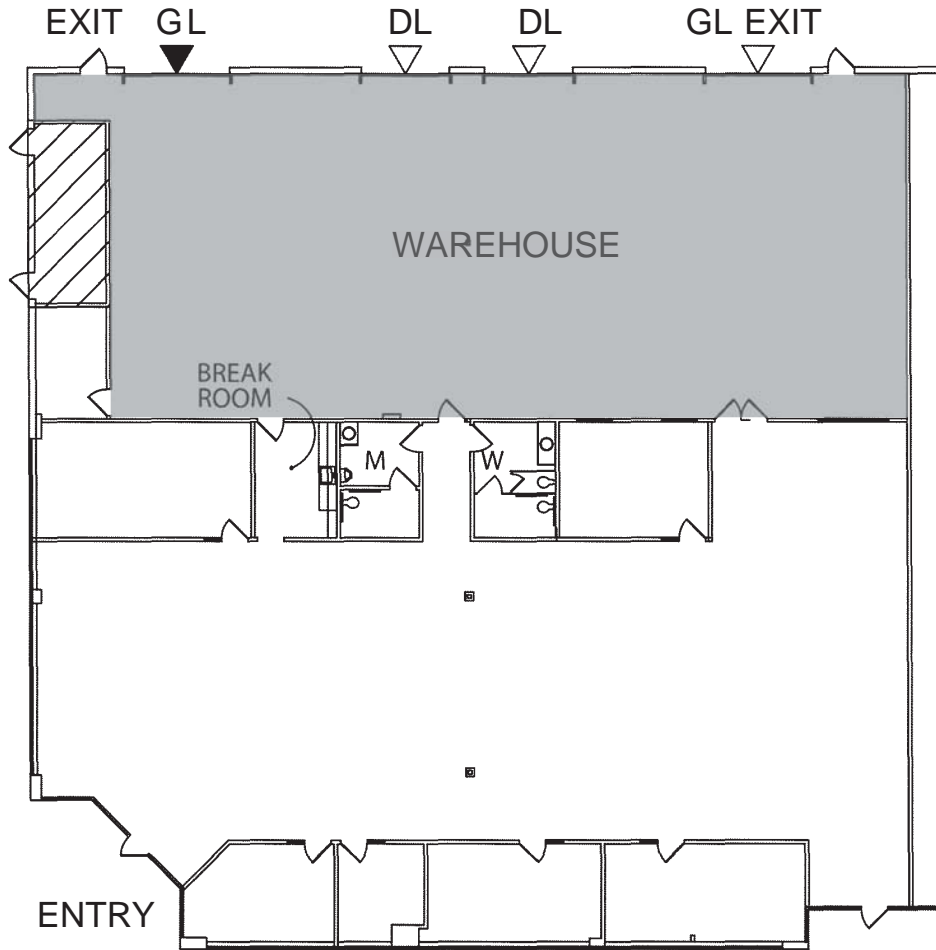

Derek Yep Director 408.987.4106 dyep@ngkf.com CA RE License #01476099

Clayton Jones Associate 650.473.4774 clayton.jones@ngkf.com CA RE License #02014728

Jon Cannon Executive Managing Director 650.688.8525 jcannon@ngkf.com CA RE License #01836599

**Newmark
Knight Frank**

2804 Mission College Boulevard., Suite 120, Santa Clara, CA 95054 www.ngkf.com